

HOW IT WORKS

1. Press the button once to activate the main mode on full beam.

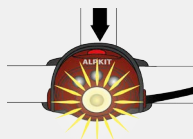

2. Press again to dim the light.

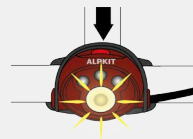

3. Press again and activate the strobe mode.

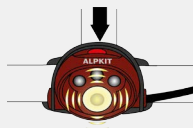

4. Press again to switch off.

1. Hold the button for 3 sec. to switch mode. This will activate the small white LED.

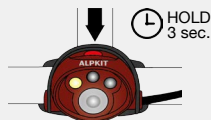

2. Press again to activate the small green LED.

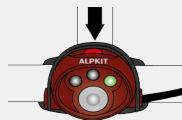

3. Press again to activate the small red LED.

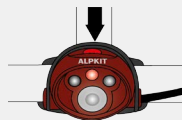

4. Press again to activate the small red flashing LED.

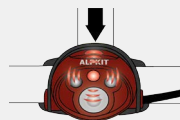

1. Press the button once to activate switch on the rear red light.



2. Press again to make it flash.



3. Press again to switch off.

CHANGING BATTERIES

1. Twist the lid to open the battery compartment.

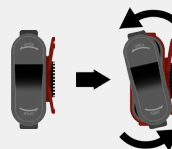

2. Insert 3 x AAA batteries as indicated on the inside of the compartment.

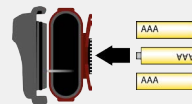

3. Push on the lid firmly and twist to close the battery compartment.

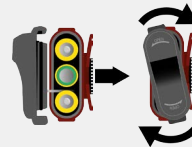

DOs AND DON'Ts

- ✓ Use good quality AAA alkaline batteries.
- Keep your Gamma clean to prevent dirt and dust from entering the electric elements.
- Remove the straps to wash them separately.
- Remove any moisture before storage.
- Store your Gamma in a dry place.
- Have a lot fun while using Gamma!

- ✗ **Do not use rechargeable batteries. Using rechargeable batteries may invalidate your warranty.**
- Do not store Gamma with batteries inside for prolonged periods of time.
- Do not attempt to push the battery lid directly, as it may put undue stress on the lugs.
- Do not shine directly into eyes.
- Do not submerge.



IMPORTANT: The battery life will vary depending upon the the brand and freshness of batteries, recovery time - time the light has been switched off, temperature and the setting used.

